

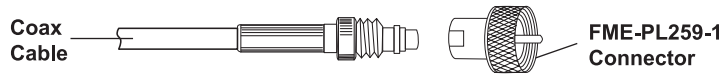

## RG-8/X Connector with UG-176 Adapter for RG-8/X Coax



If you are satisfied with the length of the coax cable, simply screw on the FME-PL259-1 connector. Otherwise, follow the instructions below.

### Installation Instructions

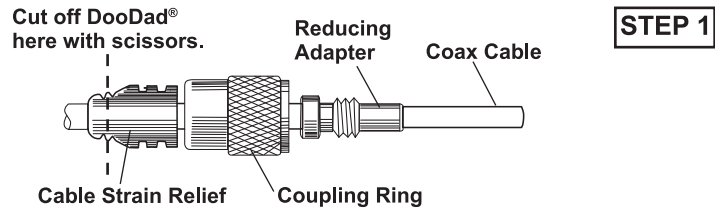

**Separate all parts to individual components.** Trim the Cable Strain Relief to fit cable, as illustrated. Slide Cable Strain Relief, coupling ring, and reducing adapter onto the cable in the order and orientation shown.

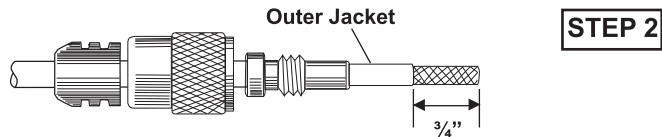

Prepare the cable according to the dimensions shown above.

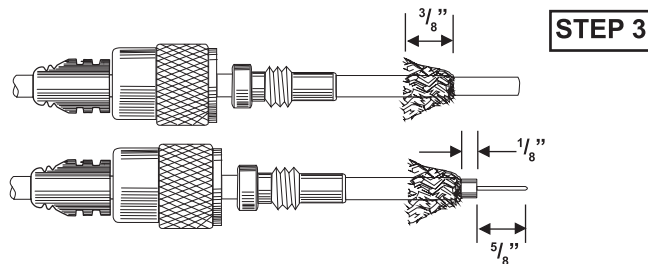

Fan the braid back, as illustrated, and trim it to  $\frac{3}{8}''$ . Strip the insulation from the center conductor as shown. **Be careful not to damage the center conductor.**

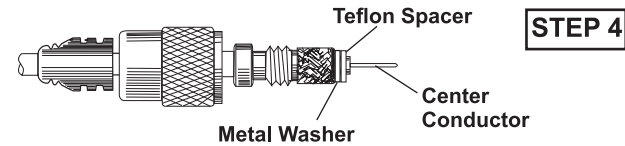

Position the adapter flush with the front edge of the cable's outer jacket and fold the braid back, over the end of the adapter as shown above. Gently twist the center conductor to bind any loose strands and carefully apply a **very thin, even** layer of solder to it. Either (1) Slide the metal washer and the Teflon spacer onto the cable in the order illustrated above OR (2) if you prefer a complete solder installation, **do not use** the metal washer or Teflon spacer, but solder the tip and then solder the braid to the connector body through the four small holes in the connector body. **Be careful not to overheat the connector.**

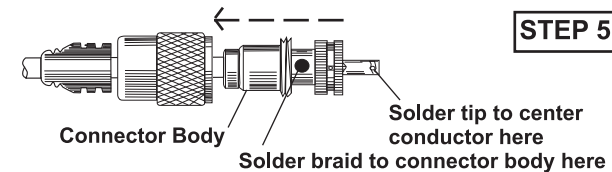

Screw the connector body tightly onto the reducing adapter and solder the tip to the center conductor. Trim off any excess center conductor. Solder the braid to the connector body through the holes. Screw the coupling ring on, and slide the Cable Strain Relief snugly onto the rear of the completed connector.

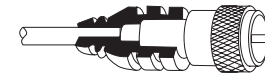

### Finished connector, showing cutaway view of Cable Strain Relief in place

KJM warrants its products to be free of defects in materials and workmanship for 5-years. KJM's obligation under this warranty is limited to repair or replace defective products. No material will be repaired or replaced without written authorization from KJM. Repair or replacement will be made only after an examination indicates defective material or workmanship at time of manufacture. KJM is in no event liable for consequential damages, installation costs or other costs of any nature incurred as a result of the use of the products manufactured by KJM, whether used in accordance with instructions or not. All shipping costs on returned material are the responsibility of the purchaser. KJM is not liable for repair or replacement of any product damaged by lightning, other natural phenomena, or incorrect installation including reverse polarity connections. This warranty is in lieu of all others, either expressed or implied. Proof of purchase is required.